

BambooTouch® decks are made of high density solid bamboo and are manufactured from compressed bamboo strips. They are heated which gives them their color (by caramelization) and durability. It is therefore a natural product that will evolve over time. Cracks and a change of shade towards grey are therefore quite normal as for all wood species. The quality of our products allows us to offer a guarantee of up to 25 years provided that the installation is done according to our instructions, respecting the rules of the country, using our accessories (clips, screws...), as well as following our recommendations for cleaning and maintenance.

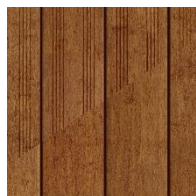

Ceylon



Espresso



Interlocking head of plank

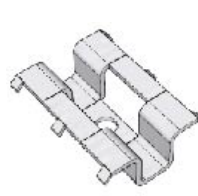

Clip for 20mm plank
Ref. : DCLIPM2

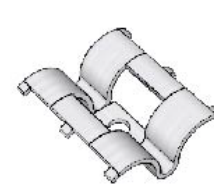

Clip for 18mm plank
Ref. : DCLIPM1

Reference	Colorr	Dimensions (mm)	Interlock Head of lank	Sides	Coating	Pose	Palet content
D20BES140.185	Espresso	20x140x1850	✓	2 (smooth/ribbed)	Oiled	Clips	256 planks 66,3m ²
D18BES140.185.S	Espresso	18x140x1850	✓	1 smooth	Oiled	Clips	273 planks 70,7m ²
D20BES178.185	Espresso	20x178x1850	✓	2 (smooth/ribbed)	Oiled	Clips	155 planks 61,4m ²
D20BCE140.220	Ceylon	20x140x2200	✓	2 (smooth / double comb)	Oiled	Clips	192 planks 59,1m ²
D18BCE140.185.S	Ceylon	18x140x1850	✓	1 smooth	Oiled	Clips	273 planks s 70,7m ²
D20BCE180.220	Ceylon	20x180x2200	✓	2 (smooth / double comb)	Oiled	Clips	155 planks 61,4m ²

Storage, installation and maintenance (DTU 51.2 or local standard)

- Planks should be stored horizontally.
- A correctly dimensioned sub-structure (plots, joists ...) must be installed according to the standards in force.
- Natural ventilation of the structure must be provided (>1% of the surface)
- Our planks, joists and accessories (plots, clips, screws) are guaranteed. We do not guarantee the use of other accessories (clips, ...) or other fixing materials (joists, battens, screws).
- We recommend the use of our solid joists.
- 3 to 6 months after installation an initial maintenance with WOCA® oil must be sheduled
- Maintenance will be done at least once or twice a year. In case of high heat/drought this period may be shortenend.
- Installation and maintenance instructions are available on our website.
www.bambootouch.com/en/advice

Technical specifications

- Brinell hardness: ±9,5 kg/mm² (EN 1534 – EPH 2717646)
- Density : ±1220 kg/m³
- Biological sustainability : Class 1 (EN 335)
- Fire standard : Bfl-S1 (EN 13501 – EPH 2717646)
- Resistance to static bending : 87 Mpa (EPH 2717646)
- Modular elasticity : 18700 Mpa (EPH 2717646)
- Formaldehyde emissions : E1 (EN 717-1 : 2004)
- Termite resistance : Class 8 (AWPA-2012, AWPA E1-09)
- Warranty : 25 year under conditions (see our website)

Aging

Bamboo is a natural product that will evolve over time. The surface of the plank may become rough as a result of the contraction/expansion cycles due to temperature and humidity variations. Small cracks, splinters and splits may appear. This does not affect the strength or durability of the plank. Also, slight dimensional change may occur after installation as the material will adjust to its new environment.

All of these phenomenon are normal as with all wood. This does not constitute a defect under the warranty.

- After installation, in very humid or rainy weather, it is possible to observe a rise of tannins on the surface. This natural phenomenon will disappear with time. You can use the WOCA® cleaning products to remove any remaining traces.
- In case of extreme weather conditions (heat, drought, ...) the planks **will require closer maintenance**.

CEYLON



After installation After 1 year After cleaning After maintenance

ESPRESSO



After installation After 1 year After cleaning After maintenance